

सुख समृद्धी
घरांचा
मंगल कलश



1RK, 1BHK & SHOPS

Stilt + 4 Floors

32 Flats

Possession DEC 2020

9Min From Rly Station

Katrap, Badlapur East.

MAHARERA P51700020811

#pehlaghar



FIRST TO FOURTH FLOOR PLAN

R O A D

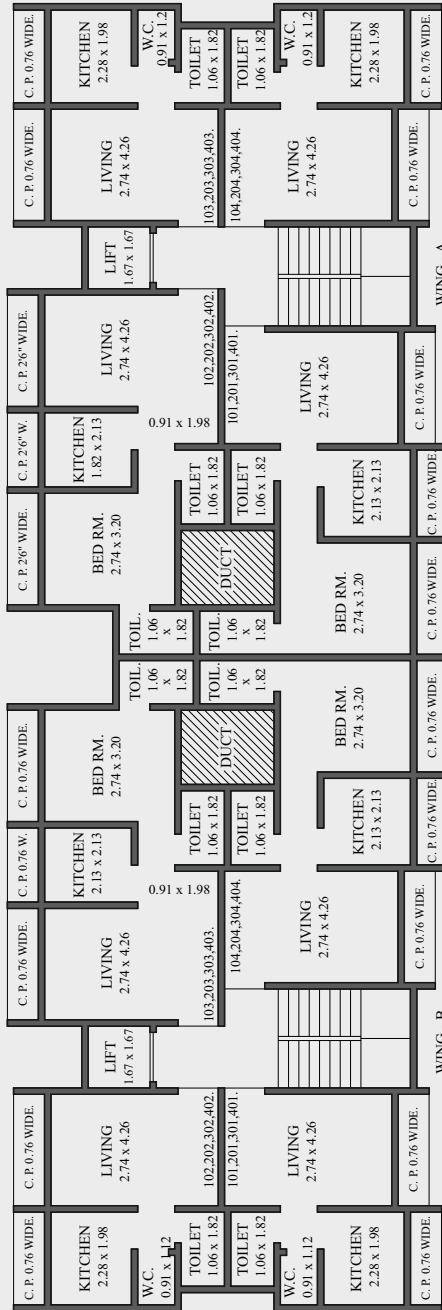



GROUND FLOOR PLAN

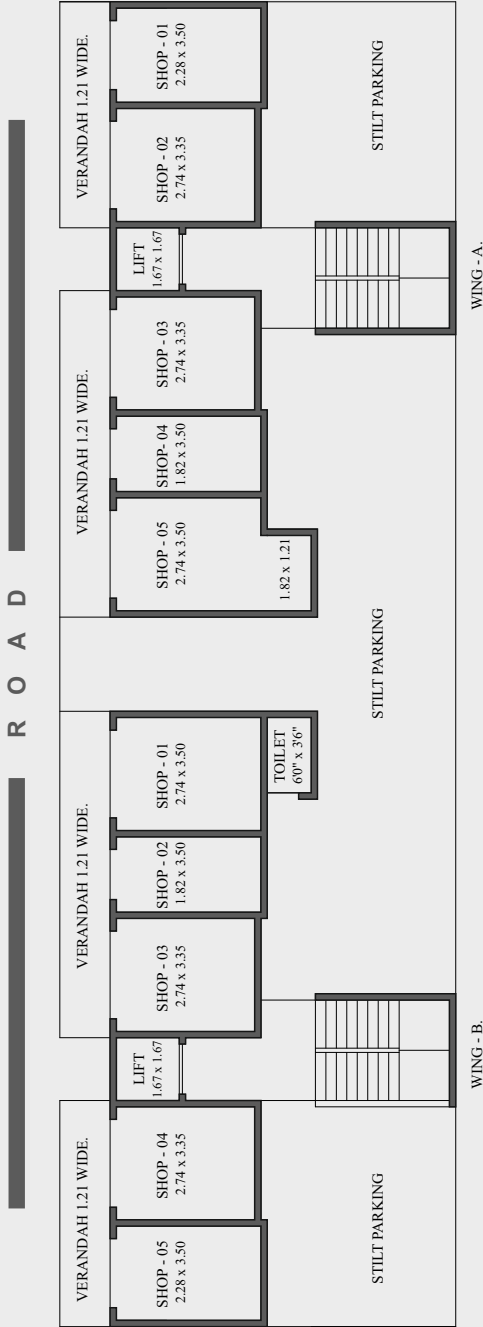

SPECIFICATION

Wall	: 6" External Wall, 4" Internal Walls
Plaster	: 2 Coat Outer Plaster
Flooring	: 2'x2' Vitrified Flooring Tiles
Electrical	: Concealed Good Quality Electrical Wiring With Adequate Electrical Points T.V. & Telephone Point In Hall & Bedroom
Window	: Powder Coated Aluminum Sliding Window With Marble Frame
Kitchen	: Kitchen Platform With Granite Top & Stainless Steel Sink, Glazed Ceramic Tiles From Platform Level Up to Dado Level
Bathroom	: Full Height Tiles In W.C & Bath Concealed Plumbing With Modern Fitting In Bath Commode In Attached Toilets Good Quality Sanitary Fitting Marble Door Frame For W.C. & Bath
Paints	: Oil Bond Distemper Paint, Oil Paints For Railings, External Painting In Superior Quality 100% Acrylic
Lift	: Reputed Branded Lift With Power Backup
POP	: Decorative POP False Ceiling In All Living Room.

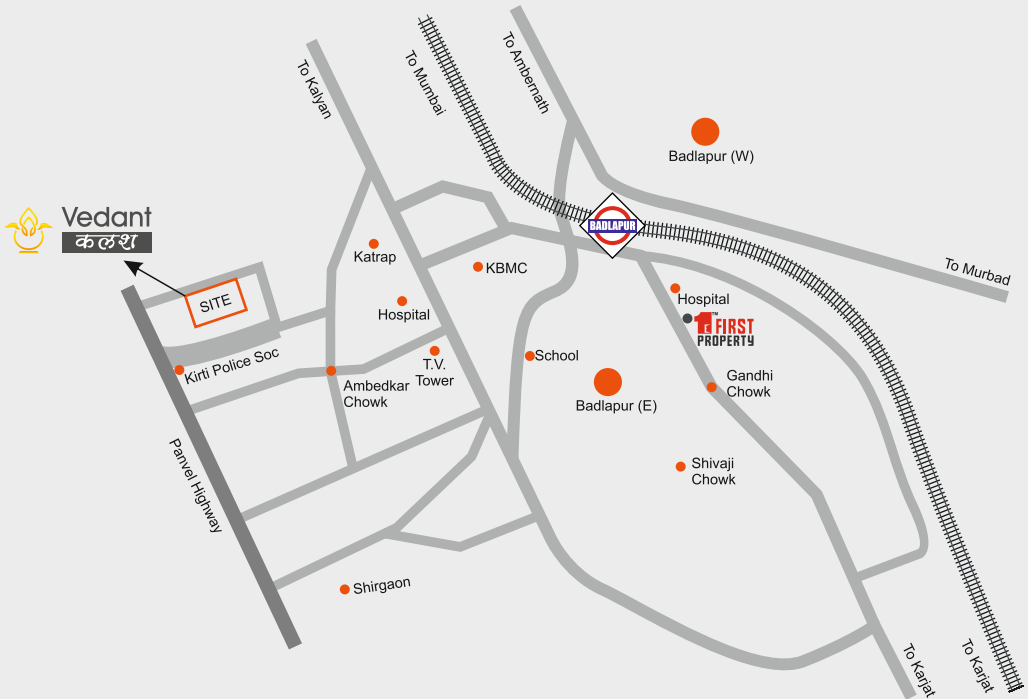

Marketed By



Regn No. : AS1700019152

9922155244 / 7722059911.

Site Off : Near Ambedkar Chowk, Katrap, Badlapur West.